

Imagine your world
without packages



Luxer Room

Specifications Overview

L U X E R[®]
ONE

Luxer Room

Add controlled access to any package room for an affordable and scalable solution.



FLEXIBLE

Accept oversized, overflow, & perishable deliveries.

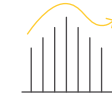

FUTURE-PROOF

Easily manage increases & fluctuations in delivery volume.



SECURE

Controlled access with 24/7 surveillance, video research, & support.

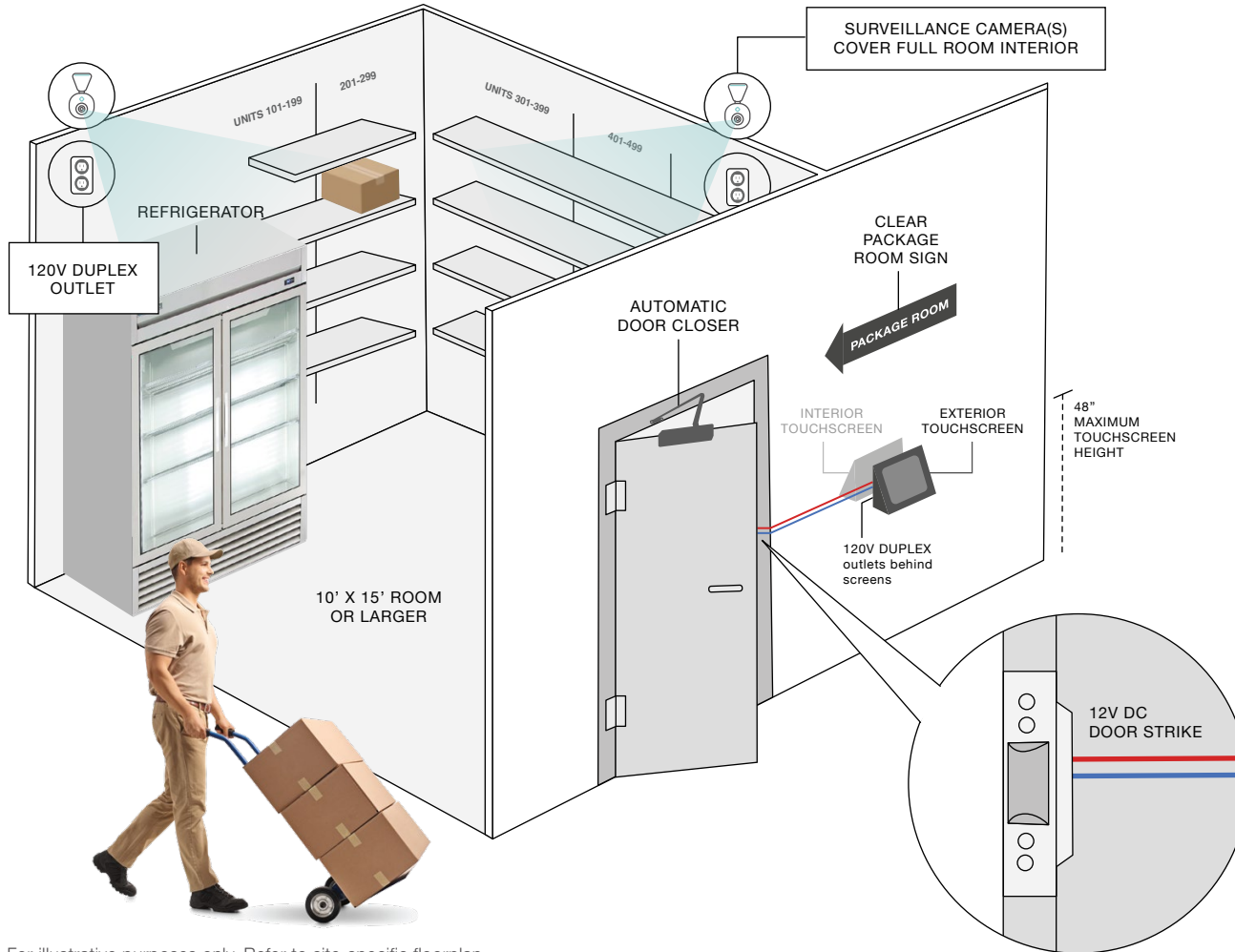

For illustrative purposes only. Refer to site-specific floorplan.

LUXER ONE PROVIDES

- Controlled access electronics for package room.
- Two touchscreens and two wall mounts.
- Two surveillance cameras with 10 days recorded video.
- Video research with 24/7 continuous support.

BUILDING PROVIDES

- Dedicated single-door access room: 10' x 15' recommended for an average 300-unit property.
- 12V DC door strike.
- 120V duplex power outlets at wall touchscreen and camera locations.
- Internet via Ethernet cable.
- Signage and shelving organized by unit number.
- Auto-locking door handle that remains unlocked on the inside.

RECOMMENDED

- Automatically closing metal door.
- Motion sensor-lighting.
- Refrigerator inside package room for perishable deliveries.
- One additional camera near the room entrance.
- Sign inside the package room stating, "This room is under video surveillance".

Touchscreen Details

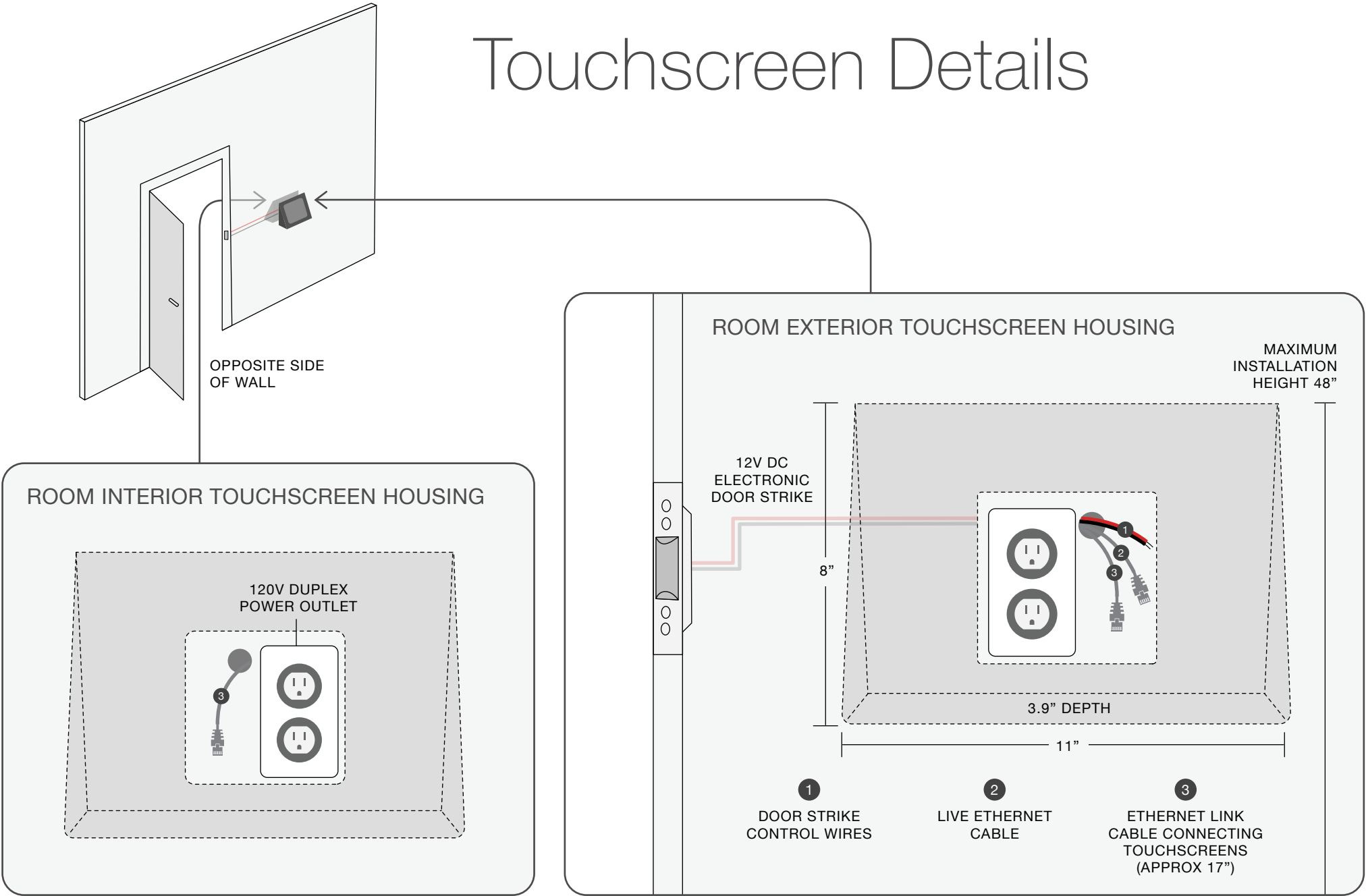

For illustrative purposes only. Refer to site-specific floorplan.